

The family bathroom was designed to be playful and youthful. **Vanity**, Old Man Magpie.



A vintage cabinet was upcycled into a **vanity** by Vanity Flair. The unlacquered tap will develop a beautiful patina. **Basin**, for similar try Villeroy & Boch.

The FACTS

Who? A single mum and her 10-year-old son

Where? Clapham, south London

What? A complete renovation and extension of a Victorian terraced three-bedroom maisonette flat

Cost? £150,000

Time? A year

Bold colours run throughout this renovation. **Chair**, for similar try The French Bedroom Company.

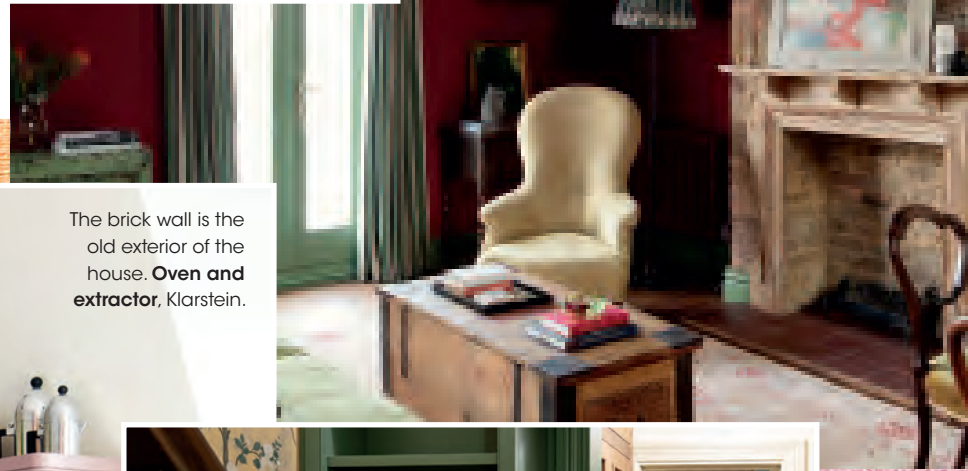

The brick wall is the old exterior of the house. **Oven and extractor**, Klarstein.



The colours of the hallway flow through into the ensuite bathroom.

BLOOMSBURY ECLECTIC INTELLECTUAL BOHEMIAN

INSPIRED BY cultural and artistic movements, these were just some of the key words included in the brief for this colourful and bold flat renovation >

Words: Georgina Townshend Photography: Matt Gamble

Illustration: iStock.com / Eugene Dudar



The brief for this maisonette flat refurbishment was inspired by unconventional artists, writers and intellectuals who explored cultural, and spiritual pursuits, such as Virginia Woolf and Andy Warhol – and it makes perfect sense, considering the owner is an archaeologist who works in research at an arts university.

“She came across me via Instagram,” explains interior designer Brooke Copp-Barton. “I remember that my use of colour, texture, vintage finds and love of brown furniture drew her eye originally.” The owner, a single mum with her 10-year-old son, lives on the upper two floors of a Victorian terrace near Clapham Junction. As part of the project, it was completely gutted, rewired, replumbed and redecorated, while the kitchen was moved from the loft to a new extension which was built on the back of the house, above the small bedroom on the first floor – and the attic becoming one large living-dining-library area.

“Along with the Bloomsbury Group, keywords for the look included eclectic, bohemian, intellectual, and Arts and Crafts. She also asked me to incorporate pre-loved and vintage items throughout and that colour should be integral to the decorative scheme,” says Brooke. The new kitchen includes pink Shaker-style cabinetry, reclaimed terracotta flooring and unlacquered brass accents – modern shiny materials were to be strongly avoided. “It’s actually one of the more restrained rooms in the flat,” laughs Brooke. “The layout was driven by its odd shape. I was unable to put in any wall units, or tall cabinets, where the wall slopes inwards. Instead, I embraced the simplicity of only adding single shelves. The colour was chosen deliberately to bring a sense of calm to the space – an antidote to the riot of colour and pattern in some of the other rooms.” Personal

touches include the fabric for the blind and sink skirt, from Japanese fabric house Minä Perhonen, which reminds the owner of good times working abroad.

In the main bedroom the original floorboards were stripped back and restored, an original Victorian fireplace reinstated and bespoke wardrobe joinery added. Its stained oak finish looks similar to the flooring, to bring warmth and texture. The 10-year-old’s space follows a slightly more modern approach, with a scaffold bookshelf, blackboard paint cupboards and a bright yellow egg pod chair. “Then in the ensuite, the shower area is tiled floor to ceiling in artisan zellige tiles,” says Brooke. “I wanted to avoid lots of shiny textures so opted for a shower curtain – made of outdoor fabric with a plain waterproof lining – and panelling around the walls outside the shower. A vintage cabinet was upcycled and turned into a vanity unit and all brassware is unlacquered brass which will develop a beautiful lived-in patina over time. There is a nod to Bloomsbury style here, too, with painted floorboards by the vanity.”

While the family bathroom, which includes a shower-bath combo, is much more of a ‘jolt to the system’, as Brooke explains: “Bold green and white encaustic tiles set the scene, with green horizontal panelling and black taps and shower accents – including a fluted screen. The idea was to make it more playful and youthful. Again, a bespoke vanity provides valuable storage, and cupboard joinery hides the washing machine and tumble dryer.”

Asked what her favourite part is, Brooke says: “I love the owner’s bravery with colours and pattern. Especially the beautiful painted wallpaper from Flora Roberts that winds through the hallway, connecting all the rooms. It is a unique space that really reflects the people who live here.” >



The wooden worktop picks up the warmth of the flooring, and fits with the brief to have no shiny materials in the kitchen.



All the joinery in the kitchen was made by Ed Keyser. The sink skirt and blind are made from fabric by Minä Perhonen and remind the owner of when she worked abroad.

The kitchen sits in a new extension that was built over a first-floor bedroom. Sink, Shaws of Darwen; cabinets and worktop, Ed Keyser.



A cupboard hides the washing machine and tumble dryer.

SMALL SPACE IDEA
If you don't have space in your kitchen, is there somewhere else you can keep your washing machine and tumble dryer? Just ensure it's safe to do so.



Zellige tiles, from Mosaic Factory have been used in the shower.



below Black elements give the family bathroom a cool edge. **Shelf**, for similar, try String Furniture; **radiator**, for similar, try Vogue UK.



A bespoke vanity, from Old Man Magpie, provides storage in the family bathroom.



Bold green and white encaustic tiles, from Bert & May set the scene. **Hand shower**, Drench.



The bespoke wardrobes in the master bedroom, from Ed Keyser, were made in a stained oak that's similar to the restored original floorboards. The fireplace is the original Victorian design, too.



The palette for the master bedroom was kept restrained, while throws and cushions pick up shades used elsewhere. **Bed**, Time4sleep; **lamp**, for similar, try Pooky.



SHOP THE LOOK

- 1 Mutina Mattonelle Margherita patterned tile, £183 per sq m, Domus. domusgroup.com
- 2 MPRO basin monobloc tap in matt black, £269, Crosswater. crosswater.co.uk
- 3 Ellie matt emulsion, £46 for 2.5 litres, Graham and Brown. grahambrown.com
- 4 Bayuban cabinet in Ebony, £2995, Oka. oka.com
- 5 Stork wall light, £162, Pooky. pooky.com >



The loft formerly housed the kitchen before the extension – it's now a large dining-living-library area. **Bookshelf**, Ed Keyser.



In the hallway, a floral wallpaper, from Flora Roberts, connects all the rooms. Stripes painted onto the stairs add extra personality.

The PLANS

Brooke Copp-Barton was tasked with a complete renovation, including a kitchen extension, of a first-floor Victorian terraced three-bedroom maisonette flat.

- 1 Extension** The kitchen sits in a new addition, which was built above a first-floor bedroom as part of the project.
- 2 Loft** Originally housing the kitchen, the space was transformed into a statement living area with large shelving unit for books as well as a dining section.
- 3 Washing** Located in the family bathroom, appliances have been tucked away within a cupboard.

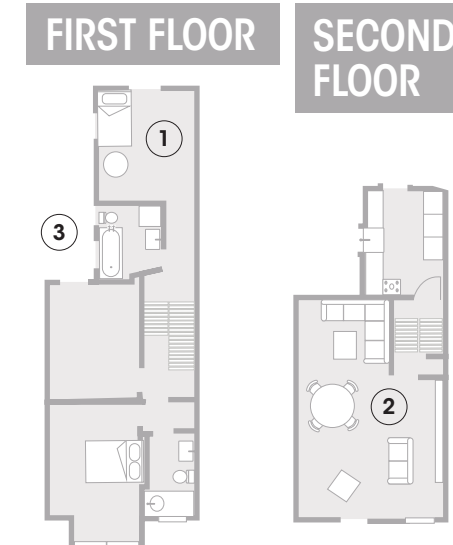

For the owner's 10-year-old son, Brooke created a modern room featuring a scaffold bookshelf and a bright yellow egg pod chair, for similar, try Nordic Haus.

SOURCEBOOK

- Design** Brooke Copp-Barton 020 8995 1240 brokecoppbarton.com
 - Kitchen joinery** Ed Keyser edkeyser.com
 - Paint** Farrow & Ball 01202 876141 farrow-ball.com
 - Oven and extractor** Klarstein klarstein.co.uk
 - Sink** Shaws of Darwen 01254 775111 shawsofdarwen.com
 - Bed** Time4sleep 01484 500560 time4sleep.co.uk
 - Bathroom tiles** Bert & May 020 3744 0776 bertandmay.com
 - Black brassware** Drench drench.co.uk
 - Bath** Drench, as before
- For full stockist information, see page 144. Search for more suppliers at thesethreerooms.com/directory **KBB**